

# specifications (mm)

	Ignition System	FireGenie Remote	Advanced Remote	B-Vent Flue	Direct Vent Flue	Zero Clearance
GFI-300L	electronic	★	-	✓	-	★
IP-28	electronic	-	★	-	-	★
IG-34	electronic	★	-	-	✓	-
I-31	manual	-	★	✓	-	★

- Not available
- ✓ Standard
- ★ Optional

Dimensions	A	B	C	D	E	F
GFI-300L	683	584	362	288	23	683
IP-28	694	593	379	N/A	N/A	694
IG-34	664	559	349	279	44	564
I-31	673	514	343	298	16	572

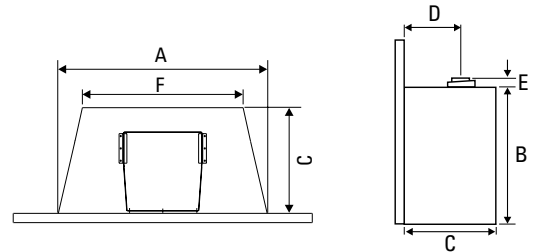

Faceplate Dimensions	Width	Height	Depth
I-31 contour fascia	1022	667	35
I-31 oversize fascia	1118	711	35
I-31 cast fascia	1035	667	35
I-31 one piece slim line fascia	906	673	3
IG-34 Contemporary fascia	1005	690	40
IG-34 Slim line fascia	981	671	25
IP-28 Modular fascia	848	655	N/A
IP-28 Modular fascia & infil panel	970	720	N/A
IP-28 Contemporary fascia	944	716	N/A
IP-28 Slim line fascia	1030	725	N/A
GFI-300L	908	682	N/A

Note: Please refer to manual for I-31 zero clearance fascia.  
Cast fascia & slim line fascia are for full masonry installation only.

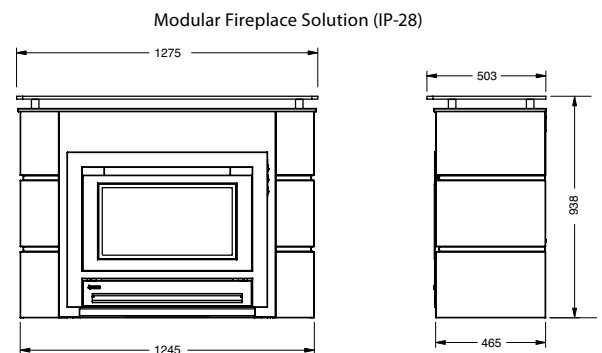

Minimum Fireplace Opening	Width (front)	Width (rear)	Height	Depth
GFI-300L	688	688	590	367
IP-28 Contemporary Fascia	699	699	597	384
IP-28 Slim Line Fascia	735	699	597	432
IG-34	680	600	586	353
I-31	673	572	533	381
I-31 Slim Line Fascia	715	572	533	381

Mock fireplace construction Framing - zero clearance	J	K	L	M
GFI-300L	650	650	420	800
IP-28 Contemporary Fascia	702	N/A	490	770
IP-28 Slim Line Fascia	702	N/A	490	770

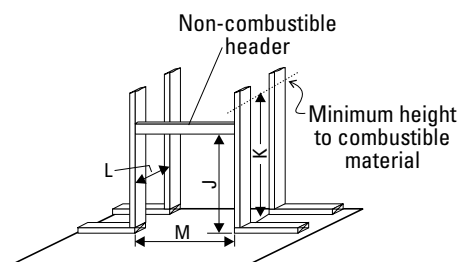

Mantel clearances*	A	B	C	D	E
GFI-300L	464	860	330	N/A	N/A
IP-28	51	1000	279	N/A	N/A
IG-34	255	1205	330	N/A <td N/A	
I-31	256	1205	330	1015	405

\* clearances shown are for 89mm mantel. For other mantel clearances please check your product manual.

A,B,C area measured from the side trim of the unit.

